

KOMPENSATOR (ŁĄCZNIK AMORTYZACYJNY) KOŁNIERZOWY PN10-PN16
FLANGED RUBBER FLEXIBLE JOINT PN10 OR PN16

ZASTOSOWANIE:

Systemy przesyłu wody i innych cieczy nieagresywnych (odpowiednie do wykonania materiałowego).

APPLICATION:

Water and other non-hazardous liquids for industrial systems (compatible with joint materials).

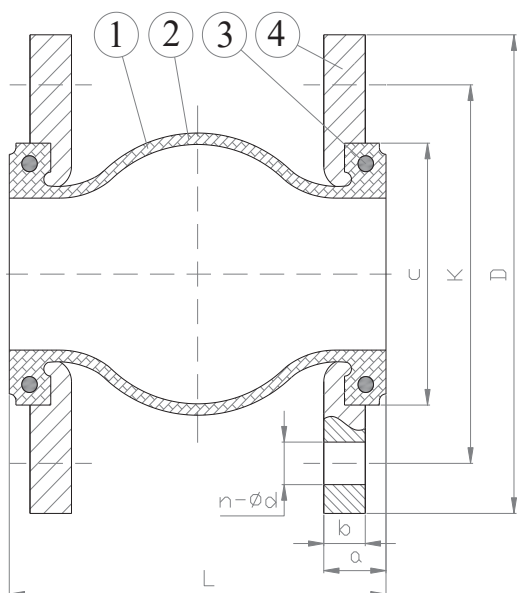

| CECHY PRODUKTU - MAIN FEATURES | |
|-------------------------------------------|------------------------------------------------------------------|
| KOŁNIERZE: TEMPERATURA ROBOCZA: | EN 1092-1 Min. -10°C (z wyłączeniem zamarzania) Max. +80°C |
| CIŚNIENIE ROBOCZE: | DN32-300 - 16 bar DN350-600 - 10 bar |
| FLANGES DRILLING: WORKING TEMPERATURE: | EN 1092-1 Min. -10°C (excluded frost) Max. +80°C |
| WORKING PRESSURE: | DN32-300 - 16 bar DN350-600 - 10 bar |

| | CZĘŚCI - PARTS | MATERIAŁY - MATERIALS |
|---|--------------------------------------|-------------------------------------|
| 1 | KORPUS BODY | EPDM EPDM |
| 2 | WZMOCNIENIE / ZBROJENIE REINFORCE | NYLON NYLON |
| 3 | OPILOT / PLECIONKA WIRE | STAL STEEL |
| 4 | KOŁNIERZ RUCHOMY FLOATING FLANGE | STAL OCYNKOWANA GALVANIZED STEEL |

| Wymiar (cale) | DN | C | K | | D | | n-ød | | b | | a | L | Odształcenie osiowe Axial displacement | | Przemieszczenie boczne Lateral displacement | Ugięcie boczne Angle of deflection | W (kg) | |
|------------------|-----|-----|------|------|------|------|-------|-------|------|------|----|-----|-------------------------------------------|--------------------------|---------------------------------------------------|---------------------------------------|--------|------|
| | | | PN10 | PN16 | PN10 | PN16 | PN10 | PN16 | PN10 | PN16 | | | Ściskanie Compression | Rozciąganie Extension | | | PN10 | PN16 |
| 1 1/4 | 32 | 77 | 100 | 100 | 140 | 140 | 4-18 | 4-18 | 15 | 15 | 23 | 95 | 10 | 6 | 10 | 25 | 3.0 | 3.0 |
| 1 1/2 | 40 | 77 | 110 | 110 | 150 | 150 | 4-18 | 4-18 | 15 | 15 | 24 | 95 | 10 | 6 | 10 | 25 | 3.6 | 3.6 |
| 2" | 50 | 88 | 125 | 125 | 165 | 165 | 4-18 | 4-18 | 15 | 15 | 24 | 105 | 10 | 6 | 10 | 25 | 4.2 | 4.2 |
| 2 1/2 | 65 | 108 | 145 | 145 | 185 | 185 | 4-18 | 4-18 | 15 | 15 | 26 | 115 | 15 | 8 | 12 | 25 | 5.3 | 5.3 |
| 3" | 80 | 120 | 160 | 160 | 200 | 200 | 8-18 | 8-18 | 17 | 17 | 27 | 135 | 15 | 8 | 12 | 25 | 6.3 | 6.3 |
| 4" | 100 | 150 | 180 | 180 | 220 | 220 | 8-18 | 8-18 | 17 | 17 | 27 | 135 | 20 | 12 | 16 | 15 | 7.0 | 7.0 |
| 5" | 125 | 180 | 210 | 210 | 250 | 250 | 8-18 | 8-18 | 19 | 19 | 29 | 165 | 20 | 12 | 16 | 15 | 9.5 | 9.5 |
| 6" | 150 | 213 | 240 | 240 | 285 | 285 | 8-23 | 8-23 | 21 | 21 | 31 | 180 | 20 | 12 | 16 | 15 | 13.0 | 13.0 |
| 8" | 200 | 263 | 295 | 295 | 340 | 340 | 8-23 | 12-23 | 21 | 21 | 33 | 205 | 20 | 12 | 16 | 15 | 17.2 | 16.6 |
| 10" | 250 | 324 | 350 | 355 | 395 | 405 | 12-23 | 12-27 | 23 | 23 | 33 | 240 | 30 | 14 | 25 | 8 | 21.7 | 23.8 |
| 12" | 300 | 374 | 400 | 410 | 445 | 460 | 12-23 | 12-27 | 23 | 25 | 40 | 260 | 30 | 14 | 25 | 8 | 28.0 | 32.8 |
| 14" | 350 | 412 | 460 | 470 | 505 | 520 | 16-23 | 16-27 | 25 | 25 | 38 | 265 | 30 | 14 | 25 | 8 | 37.0 | 42.0 |
| 16" | 400 | 475 | 515 | 525 | 565 | 580 | 16-27 | 16-30 | 25 | 27 | 43 | 265 | 30 | 14 | 25 | 8 | 46.5 | 50.0 |
| 18" | 450 | 526 | 565 | 585 | 615 | 640 | 20-27 | 20-30 | 25 | 29 | 48 | 265 | 30 | 14 | 25 | 8 | 48.7 | 62.0 |
| 20" | 500 | 575 | 620 | 650 | 670 | 715 | 20-27 | 20-33 | 27 | 29 | 48 | 265 | 30 | 14 | 25 | 8 | 61.0 | 84.0 |
| 24" | 600 | 685 | 725 | 770 | 780 | 840 | 20-30 | 20-36 | 27 | 29 | - | 265 | 30 | 14 | 25 | 8 | 68.5 | 105 |