

BIGIUNTO UNIVERSALE - PN 16 [49-71] A [318-348]
UNIVERSAL COUPLING - PN 16 [49-71] A [318-348]

APPLICAZIONE:

Collegamento di tubi per acqua in acciaio, ghisa e PE.

APPLICATION:

Steel, PE and ductile iron water pipes connections.

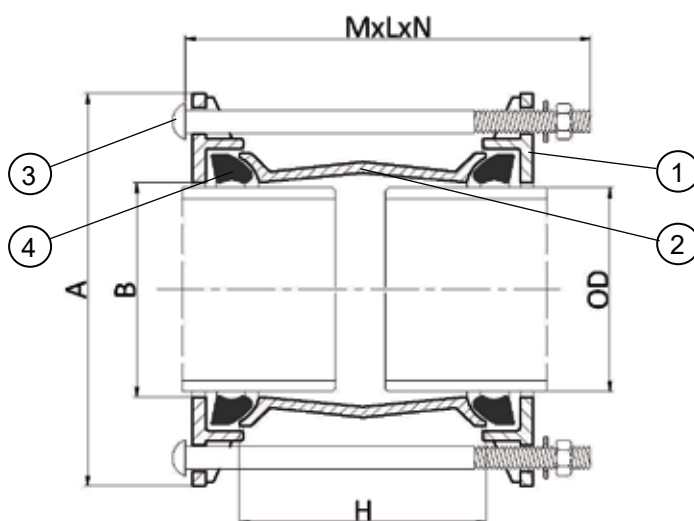

| RANGE | VITE - SCREW | | A (mm) | B (mm) | H (mm) | W (kg) |
|---------|--------------|-----|-----------|-----------|-----------|-----------|
| | M x L | NR. | | | | |
| 49-71 | 12X200 | 2 | 182 | 75.5 | 104 | 4,0 |
| 62-84 | 12X200 | 4 | 194 | 88 | 103 | 5,0 |
| 80-102 | 12X200 | 4 | 211 | 106.5 | 103 | 5,5 |
| 97-127 | 12X220 | 4 | 241 | 131.5 | 108 | 7,0 |
| 123-153 | 12X220 | 4 | 271 | 157 | 110 | 8,5 |
| 151-181 | 12X220 | 4 | 296 | 185 | 113 | 9,5 |
| 170-200 | 12X250 | 4 | 320 | 205.5 | 140 | 12,0 |
| 196-226 | 12X250 | 4 | 345 | 231 | 140 | 13,0 |
| 211-241 | 12X250 | 4 | 360 | 246 | 140 | 13,5 |
| 235-265 | 12X260 | 6 | 386 | 270.5 | 140 | 16,5 |
| 260-290 | 12X250 | 6 | 412 | 295 | 141 | 18,0 |
| 285-315 | 12X280 | 6 | 439 | 322 | 162 | 22,5 |
| 306-336 | 12X310 | 6 | 461 | 341 | 186 | 25,5 |
| 318-348 | 12X310 | 6 | 474 | 354 | 187 | 26,0 |

| CARATTERISTICHE PRINCIPALI - MAIN FEATURES | |
|--|------------|
| COLLAUDI: | EN 12266-1 |
| PRESSIONE ESERCIZIO: | Max. 16bar |
| TEMP. ESERCIZIO: | Max. +80°C |
| TESTS: | EN 12266-1 |
| WORKING PRESSURE: | Max. 16bar |
| WORKING TEMP.: | Max. +80°C |

| RANGE | COPPIA DI SERRAGGIO BOLTS TIGHTENING TORQUE |
|-----------------------|--|
| [49-71] ÷ [97-127] | 40 Nm |
| [123-153] ÷ [260-290] | 50 Nm |
| [285-315] ÷ [318-348] | 60 Nm |

| | COMPONENTI - PARTS | MATERIALI - MATERIALS |
|---|--|--|
| 1 | ANELLO END RING | EN GJS400-15 EN GJS400-15 |
| 2 | CORPO BODY | ACCIAIO RIVESTITO COATED STEEL |
| 3 | VITE, DADO, RONDELLA SCREW, NUT, WASHER | ACCIAIO 8.8 DACROMET 8.8 DACROMET STEEL |
| 4 | GUARNIZIONE GASKET | EPDM EPDM |

| RIVESTIMENTO - COATING |
|--|
| Esterno/interno con polvere epossidica di colore blu RAL 5015 e spessore 250µm. External/internal FBE coating process with epoxy resin powder of blue colour RAL 5015 and thickness of 250µm. |