

VALVOLA DI RITEGNO WAFER A DISCO PN16 DISC CHECK VALVE WAFER TYPE PN16

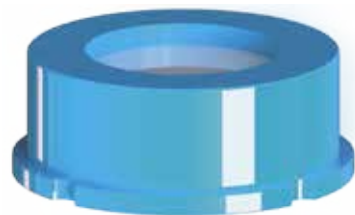

APPLICAZIONE:

Acqua e altri liquidi non pericolosi per sistemi industriali (compatibili con i materiali della valvola).

APPLICATION:

water and other non-hazardous liquids for industrial systems (compatible with valve materials).

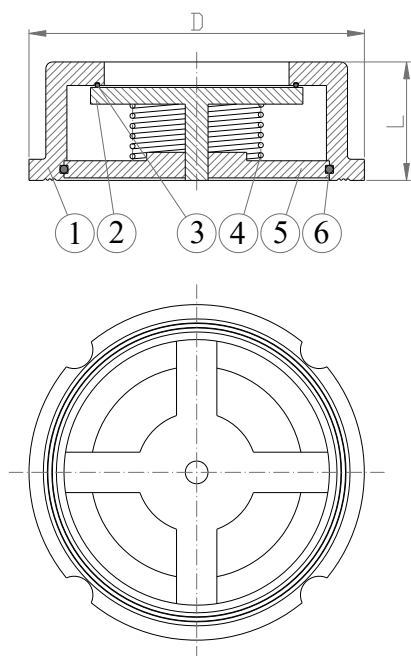

CARATTERISTICHE PRINCIPALI - MAIN FEATURES

SCARTAMANETO:	EN 558 Serie 49
COLLAUDI:	EN 12266-1
TEMPERATURA ESERCIZIO:	Max. +70°C
FACE TO FACE:	EN 558 Serie 49
TEST:	EN 12266-1
WORKING TEMPERATURE:	Max. +70°C

	COMPONENTI - PARTS	MATERIALI - MATERIALS
1	CORPO BODY	EN-GJL 250 EN-GJL 250
2	DISCO DISC	ACC.INOX AISI 304 (EN 1.4301) SS AISI 304 (EN 1.4301)
3	GUARNIZIONE SEAT GASKET	NBR NBR
4	MOLLA SPRING	ACC.INOX AISI 304 (EN 1.4301) SS AISI 304 (EN 1.4301)
5	COPERCHIO RETAINER	ACC.INOX AISI 304 (EN 1.4301) SS AISI 304 (EN 1.4301)
6	ANELLO SPRING RETAINER	ACC.INOX AISI 304 (EN 1.4301) SS AISI 304 (EN 1.4301)

RIVESTIMENTO - COATING

Esterno / interno con polvere epossidica di colore blu RAL 5005 e spessore 200µm.

External/Internal FBE coating process with epoxy resin powder of blue colour RAL 5005 and thickness of 200µm.

DN	32	40	50	65	80	100
D	82	92	107	127	142	162
L	28	31.5	40	46	50	60
W (Kg)	0.4	0.7	0.8	1.5	2.1	3.75