

GIUNTO UNIVERSALE FLANGIATO PN16 [351-378] A [630-647]
FLANGE ADAPTER PN16 [351-378] A [630-647]

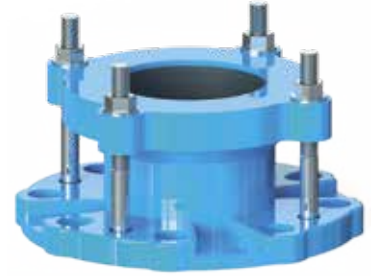

APPLICAZIONE:

Collegamento di tubi per acqua in acciaio, ghisa e PE.

APPLICATION:

Steel, PE and ductile iron water pipes connections.

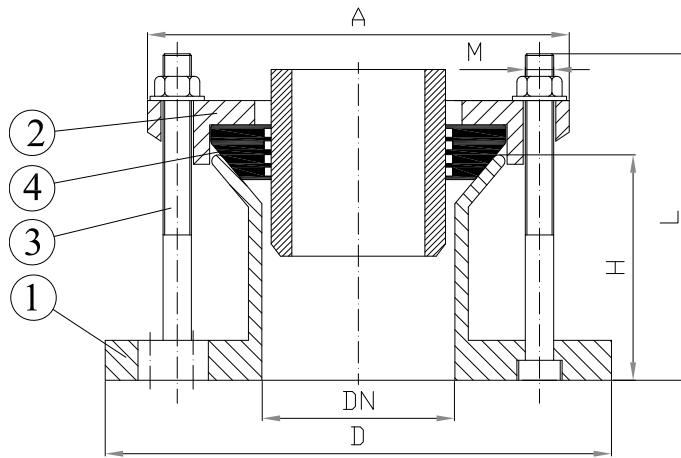

PIPE	RANGE	VITE - SCREW		A (mm)	H (mm)	D (mm)	Weight (kg)
		M x L	NR.				
DN350	351-378	M16x180	8	516	111	522	30,5
DN400	400-429	M16x180	8	570	120	584	35,4
DN450	476-493	M16x180	10	630	115	647	39,5
DN500	500-532	M16x180	10	668	123	715	52
DN600	600-630	M16x180	10	777	135	837	65,5
DN600	630-647	M16x180	10	790	135	840	63,0

CARATTERISTICHE PRINCIPALI - MAIN FEATURES	
FLANGIA:	Foratura PN10/PN16 in accordo a EN1092
COLLAUDI:	EN 12266-1
PRESSIONE ESERCIZIO:	Max. 16bar
TEMP. ESERCIZIO:	Max. +80°C
FLANGE:	Boring PN10/PN16 according to EN1092
TESTS:	EN 12266-1
WORKING PRESSURE:	Max. 16bar
WORKING TEMP.:	Max. +80°C

RANGE	COPPIA DI SERRAGGIO BOLTS TIGHTENING TORQUE
[351-378] ÷ [630-647]	75 Nm

	COMPONENTI - PARTS	MATERIALI - MATERIALS
1	CORPO BODY	EN GJS400-15 EN GJS400-15
2	ANELLO END RING	EN GJS400-15 EN GJS400-15
3	VITE, DADO, RONDELLA SCREW, NUT, WASHER	ACCIAIO 8.8 DACROMET 8.8 DACROMET STEEL
4	GUARNIZIONE GASKET	EPDM EPDM

RIVESTIMENTO - COATING
Esterno/interno con polvere epossidica di colore blu RAL 5015 e spessore 250µm. External/internal FBE coating process with epoxy resin powder of blue colour RAL 5015 and thickness of 250µm.