



Art. 054008

**GIUNTO ISOLANTE MASCHIO/SALDARE PN10****INSULATING JOINT MALE/WELDING PN10****APPLICAZIONE:**

Gas ed acqua

**APPLICATION:**

Gas and water

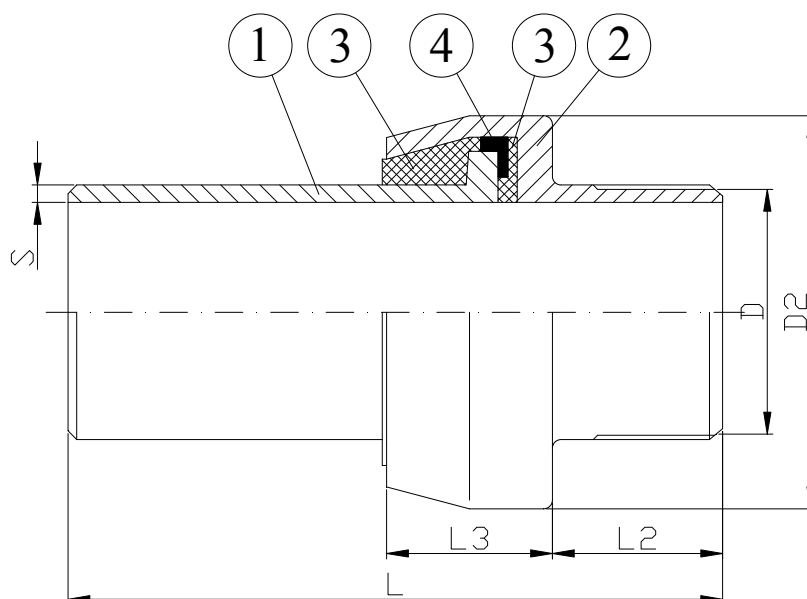
**NORME PRODOTTO:** UNI - CIG 10284**TEMPERATURA DI ESERCIZIO:** da -15 a + 70°C**TENSIONE DI ISOLAMENTO IN ARIA:** 3Kv**RESISTENZA DI ISOLAMENTO IN ARIA:** 5MΩ**FILETTATURE:** Maschio conica UNI ISO R 7/1**VERNICE EPOSSIFENOLICA****PRODUCT STANDARDS:** UNI - CIG 10284**WORKING TEMPERATURE:** from -15 to + 70°C**DIELECTRIC RESISTANCE IN DRY AIR:** 3Kv**ELECTRICAL ISULATION RESISTENCE IN DRY AIR:** 5MΩ**THREADS:** External taper thread in accordance to UNI ISO R 7/1**EPOXYPHENOLIC PAINTING**

DN	D	D2	L	L2	L3	S
20	26.7	53	110	27	30	3.25
25	33.4	60	120	29	32	3.38
32	42.2	71	135	32	35	3.56
40	48.3	77	145	32	37	3.68
50	60.3	90	150	36	38	3.91
65	76.1	113	170	40	53	5.0
80	88.9	127	200	44	53	5.49
100	114.3	156	220	55	65	6.02

**DENOMINAZIONE  
PART****MATERIALI  
MATERIALS**

1	<b>TRONCHETTO HOT FORGED SPIGOT</b>	API 5L Gr.B API 5L Gr.B
2	<b>BICCHIERE HOT FORGED SOCKET</b>	ACCIAIO ASTM-A105 STEEL ASTM-A105
3	<b>GUARNIZIONE GASKET</b>	HYTREL 40 D DUPONT HYTREL 40 D DUPONT
4	<b>DISTANZIATORE SPACER</b>	POLICARBONATO POLYCARBONATE