

RESILIENT SEATED GATE VALVE S15 (LONG BODY) • PN25

DESIGN FEATURES

- According to EN 1171, EN 1074-1 and EN 1074-2;
- Face to face dimension according to EN 558 series 15;
- Body, cover and wedge made of ductile iron EN GJS 500-7 according to EN 1563;
- Wedge coating made of vulcanized EPDM rubber according to EN 681-1 WA;
- Gasket and o-rings made of EPDM rubber according to EN 681-1 WA;
- Flange dimensions according to EN 1092-2;
- Body and bonnet connection made of 8.8 grade galvanized steel screws fully protected against corrosion;
- Shaft made of stainless steel AISI 420;
- All materials, including lubricants, in contact with water approved for human consumption according to EN 1074-1 and EN 1074-2;
- Internal and external surface protection made of epoxy resin powder (FBE), blue colour RAL 5015 and minimum thickness of 250µm;
- Hydraulic test according to EN 12266-1;
- Working temperature Min. -10°C (excluded frost) Max. + 70°C.



COMPONENTS AND MATERIALS

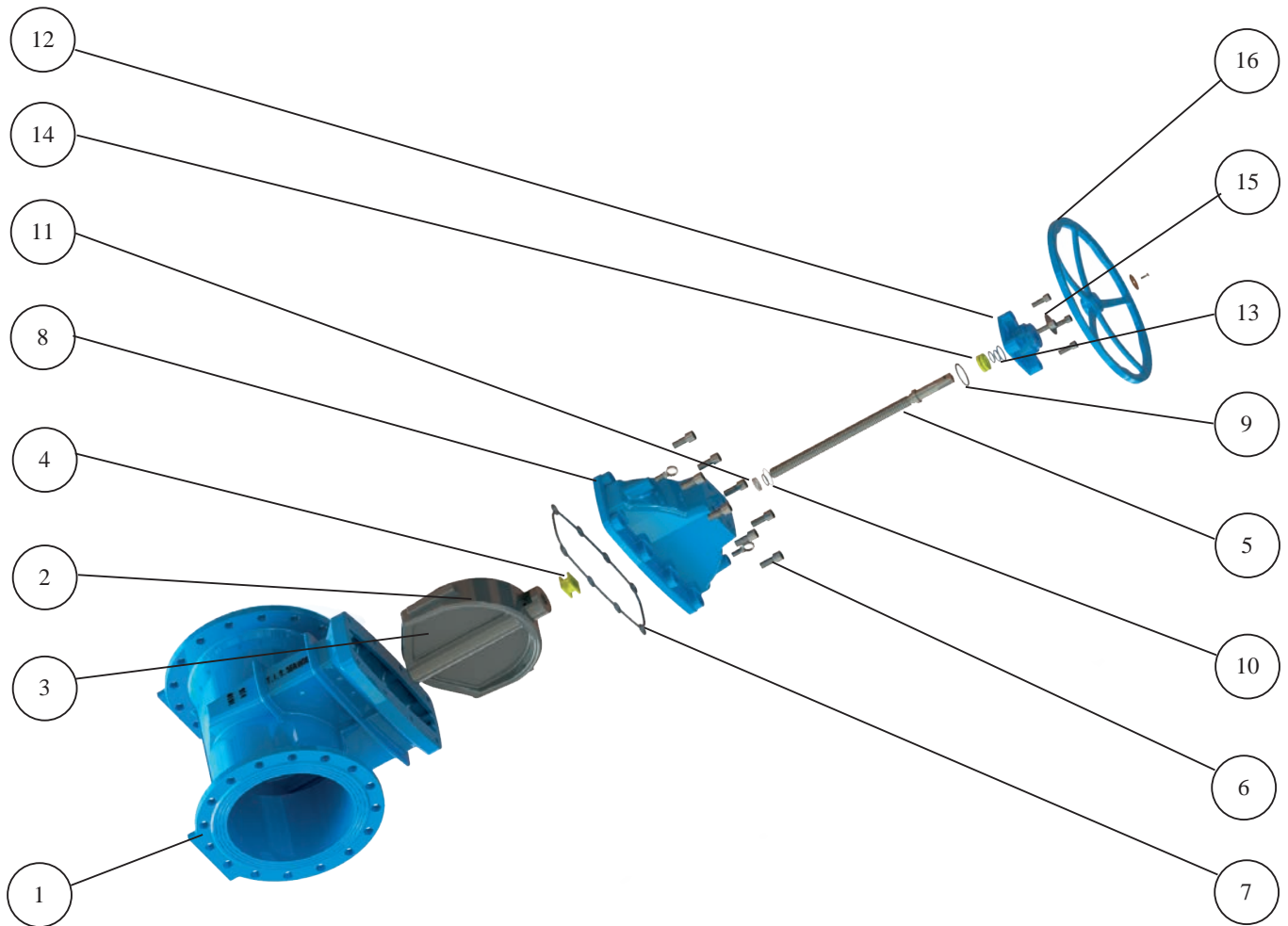

ITEM	COMPONENT	MATERIAL	NOTE
1	Body	Ductile iron EN-GJS 500-7	Epoxy coating 250 µm
2	Wedge coating	EPDM rubber	Low friction guides
3	Wedge core	Ductile iron EN-GJS 500-7	
4	Stem nut	Aluminum bronze	
5	Shaft	Stainless steel AISI 420 (EN 1.4021)	
6	Screw	Galvanized steel 8.8	
7	Main gasket	EPDM rubber	
8	Bonnet	Ductile iron EN-GJS 500-7	Epoxy coating 250 µm
9	O-ring	EPDM rubber	
10	O-ring	EPDM rubber	
11	Bushing	POM	
12	Cover	Ductile iron EN-GJS 500-7	Epoxy coating 250 µm
13	O-ring	EPDM rubber	
14	Bearing bush	Aluminum bronze	
15	Dustproof	NBR	
16	Handwheel	Ductile iron EN-GJS 500-7	Epoxy coating
-	Eye bolt	Galvanized steel	DN200 and above

DIMENSIONS AND WEIGHTS

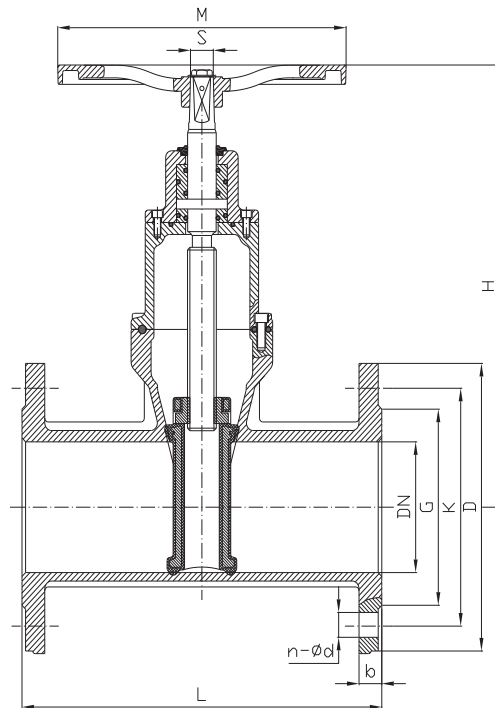

DN	G	K	D	L	H	n-ød	b	M	S	W (kg)
50	99	125	165	250	260	4-19	19	200	14	12.5
65	118	145	185	270	270	8-19	19	200	17	14
80	132	160	200	280	305	8-19	19	200	17	18.5
100	156	190	235	300	345	8-23	19	250	19	24
125	184	220	270	325	355	8-28	19	250	19	32
150	211	250	300	350	464	8-28	20	350	19	43
200	274	310	360	400	570	12-28	22	350	24	69
250	330	370	425	450	666	12-31	24.5	500	27	135
300	389	430	485	500	760	16-31	27.5	500	27	196