



Art. 054004

GIUNTO ISOLANTE MASCHIO/FEMMINA PN10**INSULATING JOINT MALE/FEMALE PN10****APPLICAZIONE:**

Gas ed acqua

APPLICATION:

Gas and water

NORME PRODOTTO: UNI - CIG 10284**TEMPERATURA DI ESERCIZIO:** da -15 a + 70°C**TENSIONE DI ISOLAMENTO IN ARIA:** 3Kv**RESISTENZA DI ISOLAMENTO IN ARIA:** 5MΩ**FILETTATURE:** Maschio conica UNI ISO R 7/1

Femmina cilindrica UNI ISO Rp 7/1

VERNICE EPOSSIFENOLICA**PRODUCT STANDARDS:** UNI - CIG 10284**WORKING TEMPERATURE:** from -15 to + 70°C**DIELECTRIC RESISTANCE IN DRY AIR:** 3Kv**ELECTRICAL ISULATION RESISTENCE IN DRY AIR:** 5MΩ**THREADS:** External taper thread in accordance to UNI ISO R 7/1

Internal parallel thread in accordance to UNI ISO Rp 7/1

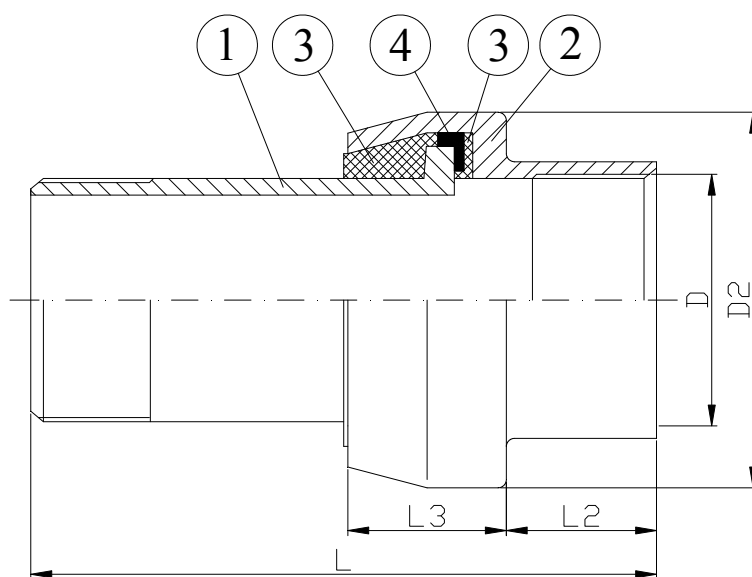
EPOXYPHENOLIC PAINTING

DN	D	D2	L	L2	L3
20	26.7	53	110	27	30
25	33.4	60	120	29	32
32	42.2	71	135	32	35
40	48.3	77	145	32	37
50	60.3	90	150	36	38
65	76.1	113	170	40	53
80	88.9	127	200	44	53
100	114.3	156	220	55	65

DENOMINAZIONE PART	MATERIALI MATERIALS
1 TRONCHETTO HOT FORGED SPIGOT	API 5L Gr.B API 5L Gr.B
2 BICCHIERE HOT FORGED SOCKET	ACCIAIO ASTM-A105 STEEL ASTM-A105
3 GUARNIZIONE GASKET	HYTREL 40 D DUPONT HYTREL 40 D DUPONT
4 DISTANZIATORE SPACER	POLICARBONATO POLYCARBONATE