

FLANGE FITTINGS

Ti.S

Service

90° - Art. 060004

45° - Art. 060003

22° - Art. 060002

11° - Art. 060001

CURVA A DUE FLANGE 90° - 45° - 22° - 11° PN10

DOUBLE FLANGED BENDS 90° - 45° - 22° - 11° PN10

CURVA 90°

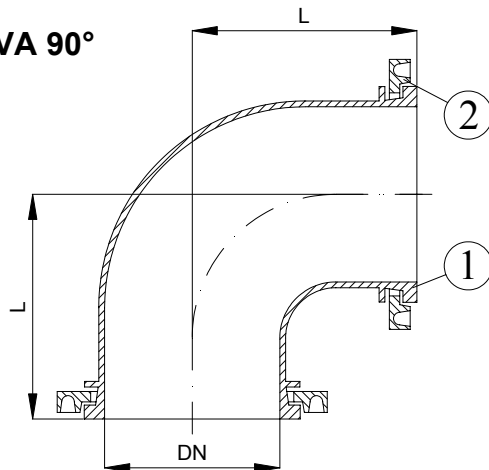

CURVA 45°

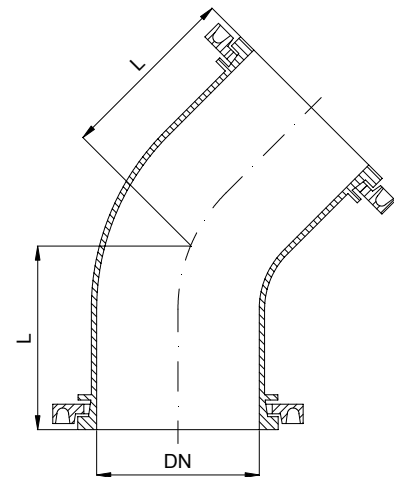

CURVA 22°

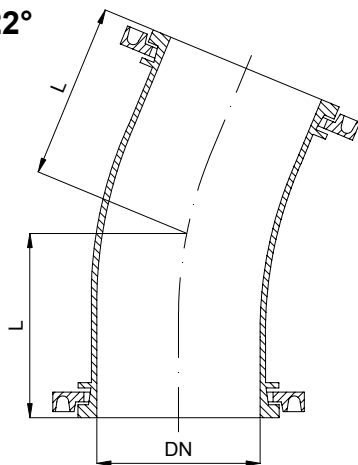

CURVA 11°

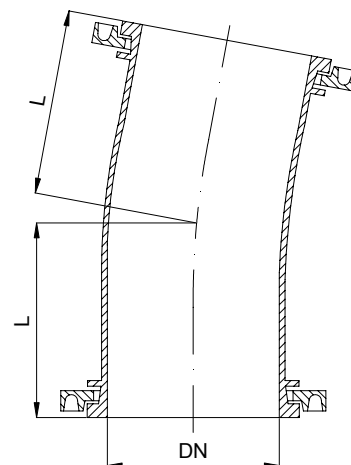

DN	90°		45°		22°		11°	
	L	W(kg)	L	W(kg)	L	W(kg)	L	W(kg)
65	160	8	160	10	114	7	120	7.5
80	165	11	130	10	105	8.5	115	8.5
100	180	14	140	14	110	10.5	115	10.5
125	200	16	150	15	105	14	110	13
150	220	22	160	21	109	16.5	115	17
200	260	34	180	30	131	26.5	130	26
250	350	55	245	49	167	41	105	38
300	400	75	275	65	175	54	115	51

DENOMINAZIONE
PARTMATERIALI
MATERIALS1 CORPO
BODYGJS 400
GJS 4002 FLANGE ORIENTABILI
LOOSE FLANGESGJS 400
GJS 400

RIVESTIMENTO ESTERNO/INTERNO: Polvere epossidica di colore BLU con spessore min 250 μ m.
SURFACE PROTECTION: FBE coating process with epoxy resin powder of sky blue color and minimum thickness of 250 μ m.

Art. 060010

TEE A 3 FLANGE PN10

ALL FLANGED TEES PN10

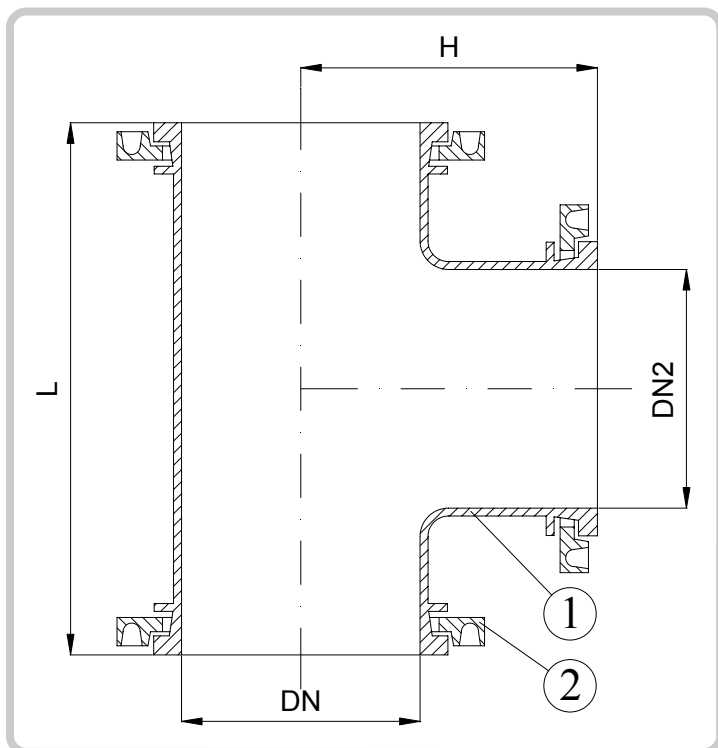
DENOMINAZIONE
PARTMATERIALI
MATERIALS1 CORPO
BODYGJS 400
GJS 4002 FLANGE ORIENTABILI
LOOSE FLANGESGJS 400
GJS 400

RIVESTIMENTO ESTERNO/INTERNO: Polvere epossidica di colore BLU con spessore min 250 μ m.

SURFACE PROTECTION: FBE coating process with epoxy resin powder of sky blue color and minimum thickness of 250 μ m.

DN	DN2	L	H	W(kg)
65	40	280	140	10
65	65	320	160	13
80	40	310	135	12
80	65	330	165	16
80	80	330	165	16
100	50	320	145	14
100	65	330	165	19
100	80	360	175	20
100	100	360	180	22
125	50	330	160	19
125	65	330	180	22
125	80	400	190	24
125	100	400	195	24

DN	DN2	L	H	W(kg)
125	125	400	200	26
150	50	340	170	26
150	65	340	190	28
150	80	440	205	30
150	100	440	210	32
150	125	440	215	33
150	150	440	220	35
200	65	365	215	36
200	80	520	235	45
200	100	520	240	45
200	125	435	240	42
200	150	520	250	51
200	200	520	260	58

DN	DN2	L	H	W(kg)
250	80	405	265	54
250	100	700	275	55
250	125	475	275	60
250	150	480	280	60
250	200	700	325	77
250	250	700	350	88
300	100	800	300	73
300	125	505	310	70
300	150	505	310	71
300	200	800	350	97
300	250	620	330	88
300	300	800	400	125
400	400	840	420	195

CROCE PN 10

ALL FLANGED CROSSES PN10

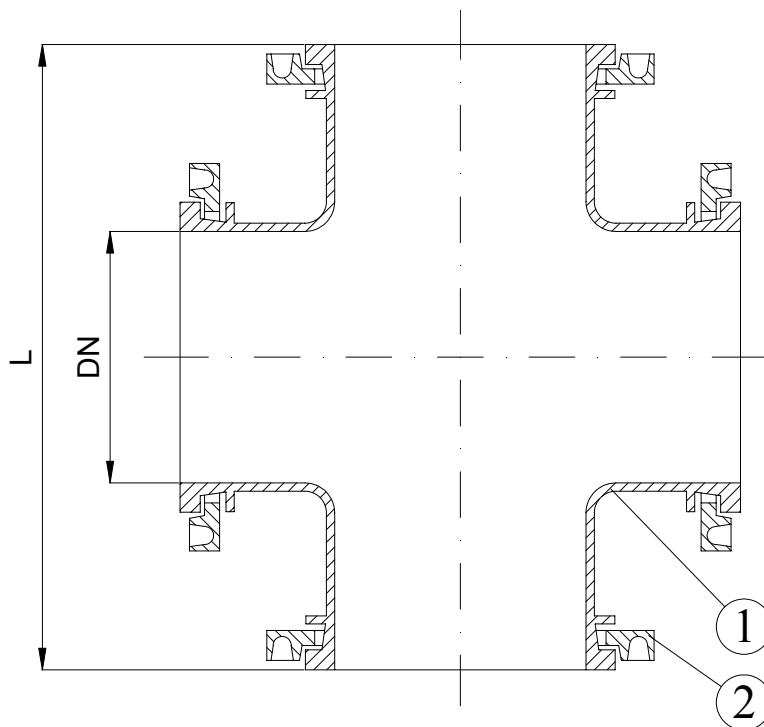

DN	L	W(kg)
65	300	16
80	330	25.5
100	360	26
125	400	31
150	440	42
200	520	63
250	660	103
300	800	142

DENOMINAZIONE PART	MATERIALI MATERIALS
1 CORPO BODY	GJS 400 GJS 400
2 FLANGE ORIENTABILI LOOSE FLANGES	GJS 400 GJS 400

RIVESTIMENTO ESTERNO/INTERNO: Polvere epossidica di colore BLU con spessore min 250µm.
SURFACE PROTECTION: FBE coating process with epoxy resin powder of sky blue color and minimum thickness of 250µm.

Art. 060016

RIDUZIONE A DUE FLANGE PN 10

DOUBLE FLANGED TAPERS PN10

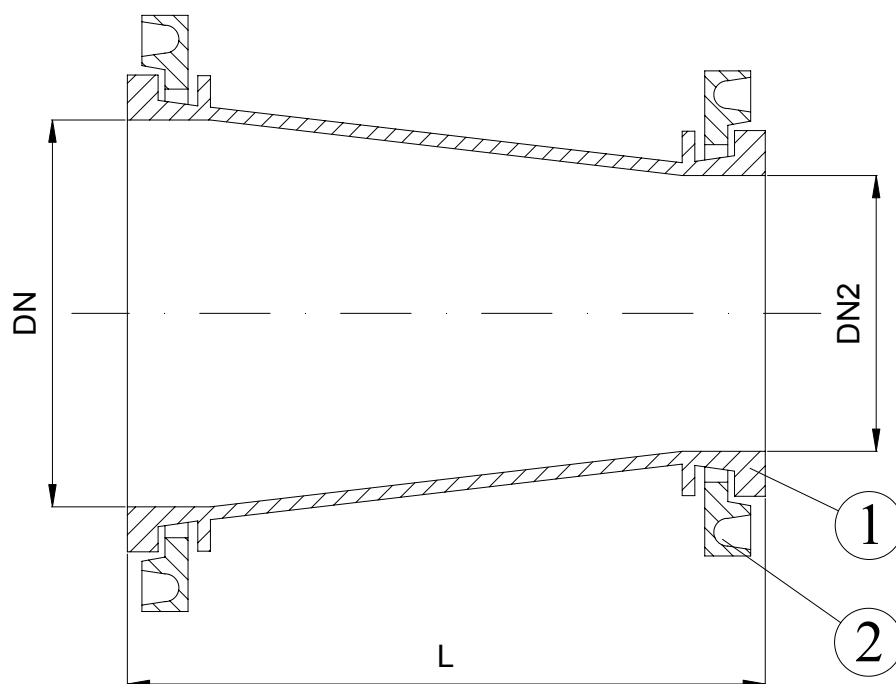

DN	DN2	L	W(kg)
80	60	200	9
100	60	230	11
100	80	200	11
125	80	200	12
125	100	200	12
150	80	200	16
150	100	305	17
150	125	200	15
200	80	300	21
200	100	300	22
200	125	300	23
200	150	275	26
250	200	300	35
300	200	300	39
300	250	300	46
400	300	600	90

DENOMINAZIONE PART	MATERIALI MATERIALS
1 CORPO BODY	GJS 400 GJS 400
2 FLANGE ORIENTABILI LOOSE FLANGES	GJS 400 GJS 400

RIVESTIMENTO ESTERNO/INTERNO: Polvere epossidica di colore BLU con spessore min 250 μ m.

SURFACE PROTECTION: FBE coating process with epoxy resin powder of sky blue color and minimum thickness of 250 μ m.

GIUNZIONE AD UNA FLANGIA PN 10

FLANGED SPIGOTS PN10

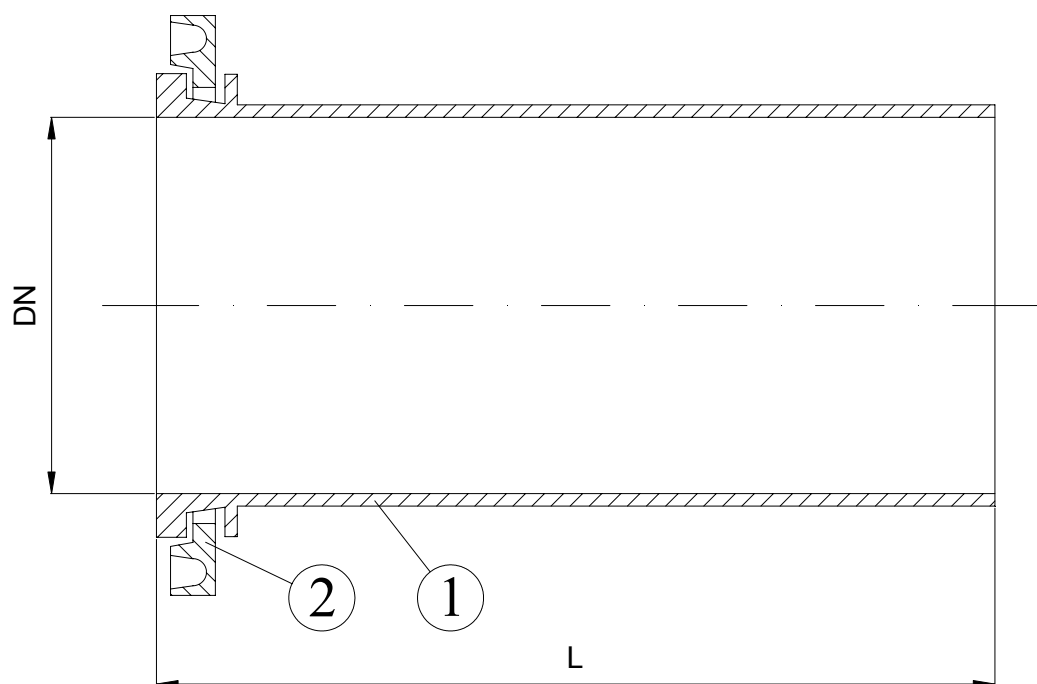

DN	L	W(kg)
65	345	7
80	350	9
100	360	11
125	370	13
150	375	18
200	375	29
250	420	34
300	440	50
400	480	69

DENOMINAZIONE PART	MATERIALI MATERIALS
1 CORPO BODY	GJS 400 GJS 400
2 FLANGE ORIENTABILI LOOSE FLANGES	GJS 400 GJS 400

RIVESTIMENTO ESTERNO/INTERNO: Polvere epossidica di colore BLU con spessore min 250µm.
SURFACE PROTECTION: FBE coating process with epoxy resin powder of sky blue color and minimum thickness of 250µm.

FLANGE FITTINGS

TiS

Service

90° - Art. 060020

45° - Art. 060023

22° - Art. 060022

11° - Art. 060021

CURVA A DUE BICCHIERI 90° - 45° - 22° - 11°

DOUBLE SOCKET BENDS 90° - 45° - 22° - 11°

CURVA 90°

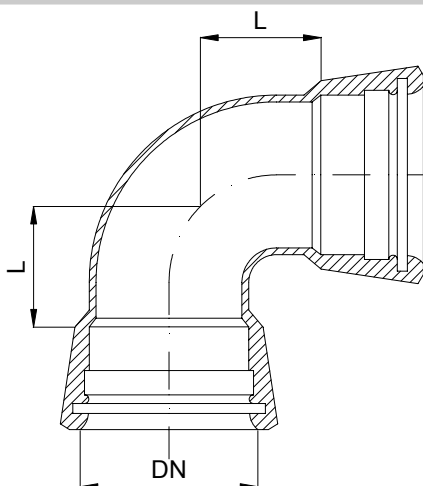

CURVA 45°

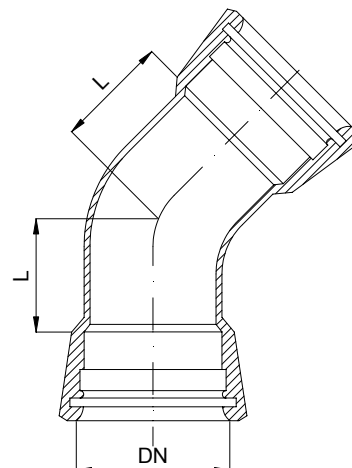

CURVA 22°

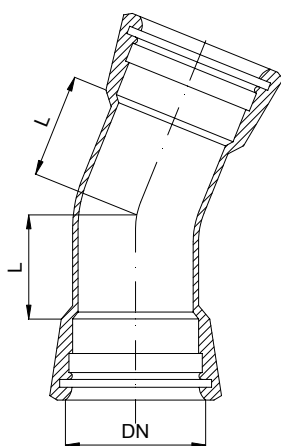

CURVA 11°

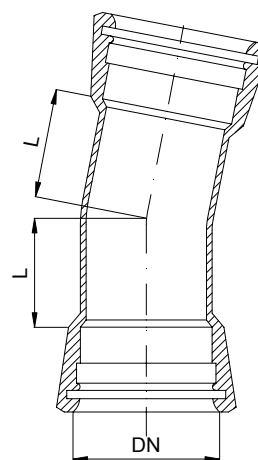

DN	90°		45°		22°		11°	
	L	W(kg)	L	W(kg)	L	W(kg)	L	W(kg)
65	80	12	45	12	25	11	35	11
80	105	17	55	16	30	16	40	16
100	115	20	65	19	30	18	40	17
125	145	25	75	22	35	22	50	21
150	150	31	85	29	35	25	55	26
200	194	45	110	38	40	34	65	36
250	251	67	106	54	75	-	50	-
300	276	91	106	71	85	-	55	-
400	420	165	189	120	110	-	65	-

DENOMINAZIONE
PARTMATERIALI
MATERIALS1 CORPO
BODYGJS 400
GJS 400

RIVESTIMENTO ESTERNO/INTERNO: Polvere epossidica di colore BLU con spessore min 250µm.

SURFACE PROTECTION: FBE coating process with epoxy resin powder of sky blue color and minimum thickness of 250µm.

TEE A 2 BICCHIERI

DOUBLE SOCKET TEES WITH FLANGED BRANCH

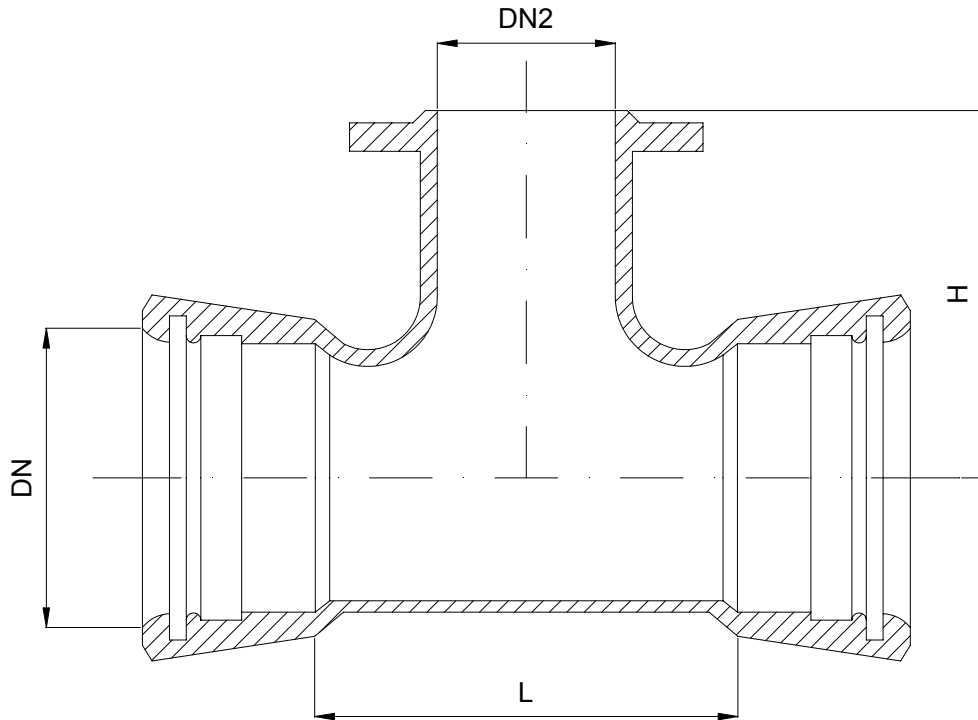

DN	DN2	L	H	W(kg)
60	60	120	150	17
80	60	170	155	21
80	80	144	165	23
100	60	215	165	24
100	80	170	175	26
100	100	162	182	27
125	100	191	195	29
125	125	223	200	33
150	150	210	220	44
200	100	206	240	46

DENOMINAZIONE PART	MATERIALI MATERIALS
1 CORPO BODY	GJS 400 GJS 400

RIVESTIMENTO ESTERNO/INTERNO: Polvere epossidica di colore BLU con spessore min 250µm.
SURFACE PROTECTION: FBE coating process with epoxy resin powder of sky blue color and minimum thickness of 250µm.

GIUNZIONE AD UNA FLANGIA CON BICCHIERE
FLANGED SOCKET

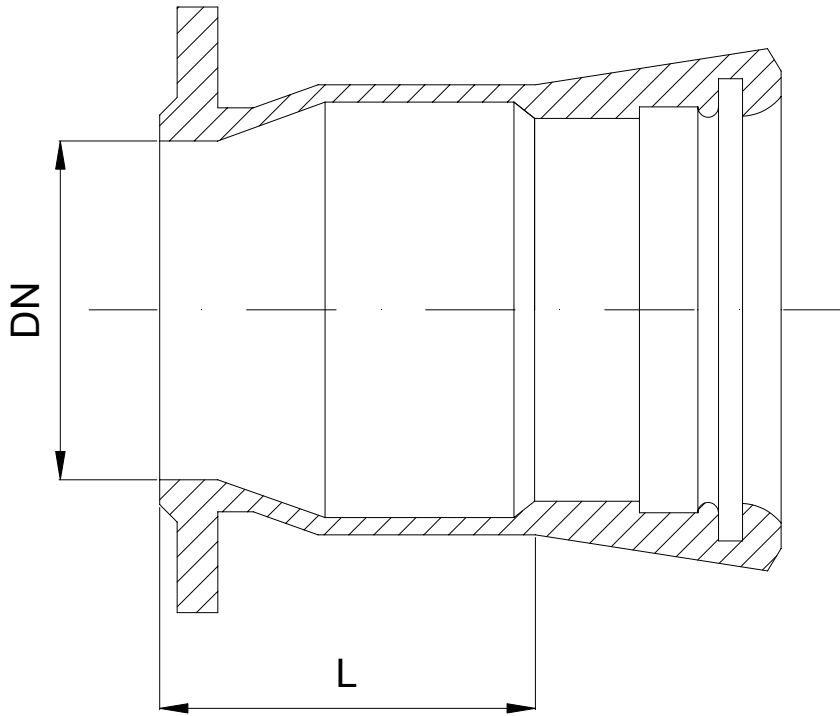

DN	L	W(kg)
65	130	10
80	144	13
100	141	15
125	123	16
150	135	22
200	140	29
250	135	37
300	140	48
400	150	81

DENOMINAZIONE
PART

MATERIALI
MATERIALS

1 CORPO
BODY

GJS 400
GJS 400

RIVESTIMENTO ESTERNO/INTERNO: Polvere epossidica di colore BLU con spessore min 250 μ m.
SURFACE PROTECTION: FBE coating process with epoxy resin powder of sky blue color and minimum thickness of 250 μ m.

MANICOTTO A DUE BICCHIERI
DOUBLE SOCKET

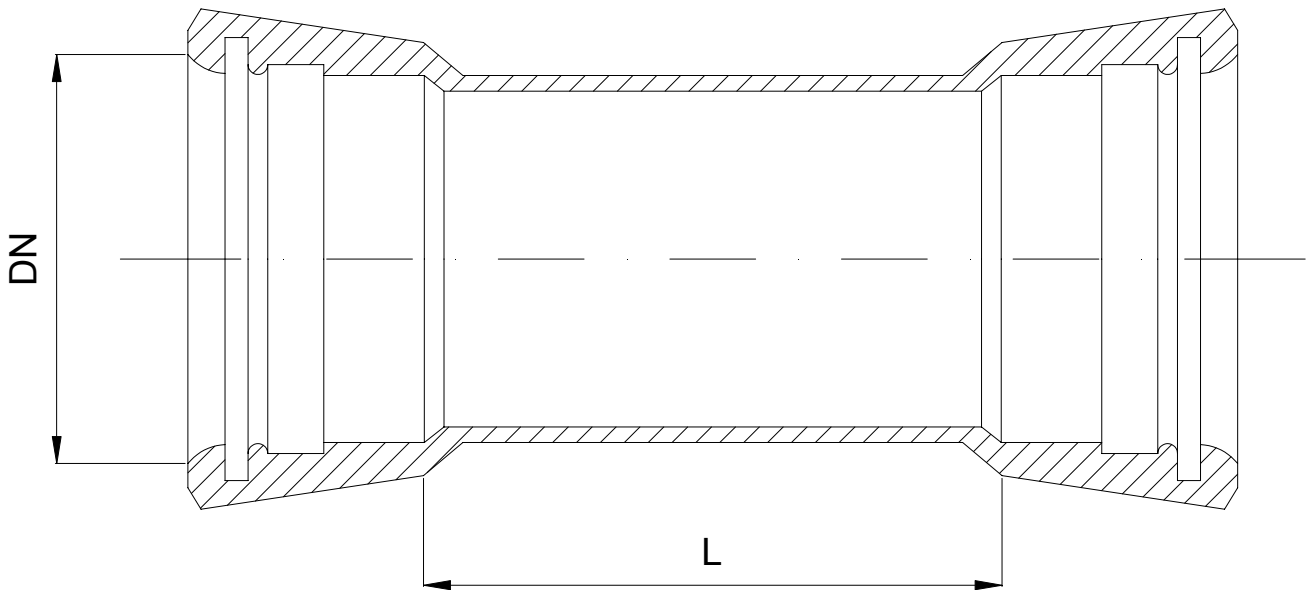

DN	L	W(kg)
65	156	12.2
80	160	15
100	160	19
125	165	22.5
150	167	28
200	170	37
250	175	49
300	180	62.5
350	185	76
400	190	91

DENOMINAZIONE PART	MATERIALI MATERIALS
1 CORPO BODY	GJS 400 GJS 400

RIVESTIMENTO ESTERNO/INTERNO: Polvere epossidica di colore BLU con spessore min 250µm.
SURFACE PROTECTION: FBE coating process with epoxy resin powder of sky blue color and minimum thickness of 250µm.