

PN 10 - Art. N325 TIS

PN 16 - Art. N326 TIS

PN 25 - Art. N327

GIUNTI DI SMONTAGGIO

DISMANTLING JOINTS

APPLICAZIONE:

Facilita il montaggio/smontaggio delle valvole specialmente per grandi diametri.

APPLICATION:

Used to facilitate the assembling/disassembling of the valve (in particular for big diameters).

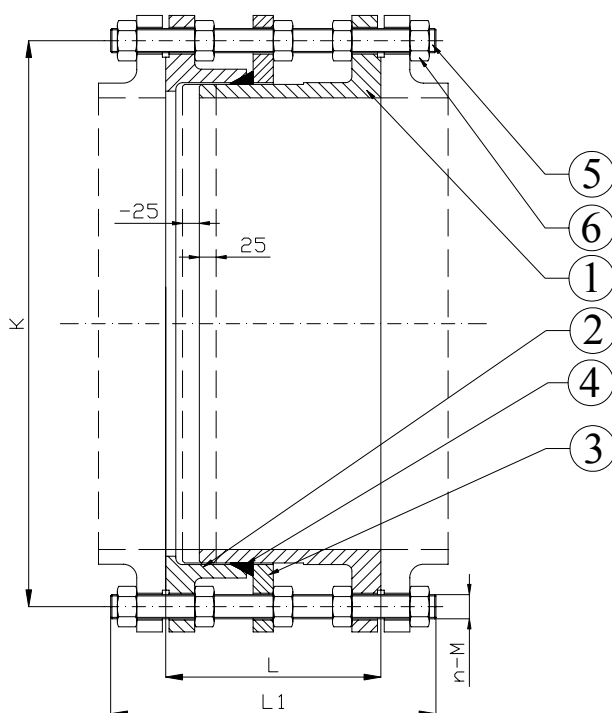
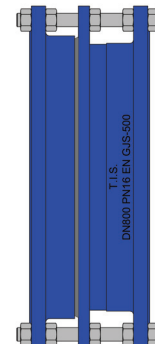

FLANGE: EN 1092-2
TEMP. ESERCIZIO: Min -15°C/Max+80°C
FLANGES: EN 1092-2
WORKING TEMP.: Min -15°C/Max+80°C

DENOMINAZIONE PART	MATERIALI MATERIALS
1 TUBO FLANGIATO - LUNGO FLANGED PIPE - LONG	GJS 500 GJS 500
2 TUBO FLANGIATO - CORTO FLANGED PIPE - SHORT	GJS 500 GJS 500
3 FLANGIA DI RITEGNO RETAINING	ACCIAIO ST37 STEEL ST37
4 ANELLO DI TENUTA SEALING RING	EPDM EPDM
5 VITE PRIGIONIERA STUD BOLT	ACCIAIO ZINCATO GALVANIZED STEEL
6 DADO NUT	ACCIAIO ZINCATO GALVANIZED STEEL

RIVESTIMENTO ESTERNO/INTERNO: Polvere epossidica di colore BLU RAL 5005 con spessore min 250µm.
SURFACE PROTECTION: FBE coating process with epoxy resin powder of sky blue color RAL 5005 and minimum thickness of 250µm.

DN		80	100	125	150	200	250	300	350	400	450	500	600	700	800	900	1000	1200
PN 10	L	200	200	200	200	220	220	220	230	230	-	260	260	260	290	290	290	320
	L1	350	350	350	350	380	380	390	400	410	-	460	460	460	500	500	510	570
	n-M	8-16	8-16	8-16	8-20	8-20	12-20	12-20	16-20	16-24	-	20-24	20-27	24-27	24-30	28-30	28-33	32-36
	K	160	180	210	240	295	350	400	460	515	-	620	725	840	950	1050	1160	1380
	W(kg)	18	20	24	30	42	62	67	85	105	-	155	225	300	361	400	516	895
PN 16	L	200	200	200	200	220	230	250	260	270	-	280	300	300	320	320	340	360
	L1	350	350	350	350	380	400	420	440	460	-	490	520	520	550	560	600	650
	n-M	8-16	8-16	8-16	8-20	12-20	12-24	12-24	16-24	16-27	-	20-30	20-33	24-33	24-36	28-36	28-39	32-45
	K	160	180	210	240	295	355	410	470	525	-	650	770	840	950	1050	1170	1390
	W(kg)	18	20	24	30	45	66	84	107	142	-	200	305	321	469	535	698	1070
PN 25	L	-	220	220	230	230	250	250	270	280	280	300	320	340	360	380	400	450
	L1	-	340	370	370	370	410	410	480	500	480	500	520	530	600	600	650	720
	n-M	-	8-20	8-24	8-24	12-24	12-27	16-27	16-30	16-33	20-33	20-33	20-36	24-39	24-45	28-45	28-52	32-52
	K	-	190	220	250	310	370	430	490	550	600	660	770	875	990	1090	1210	1420
	W(kg)	-	32	43	52	76	108	129	196	212	281	290	389	505	690	920	1257	1870