

PN 16 Art. C086 TIS
PN 10 Art. C087 TIS

VALVOLA DI RITEGNO ASSIALE PN10/16
AXIAL DISC CHECK VALVE PN10/16

APPLICAZIONE:

Stazioni di pompaggio per acqua, irrigazione e depurazione acque.

APPLICATION:

Pumping stations and networks for clean water distribution, irrigation and water treatment.

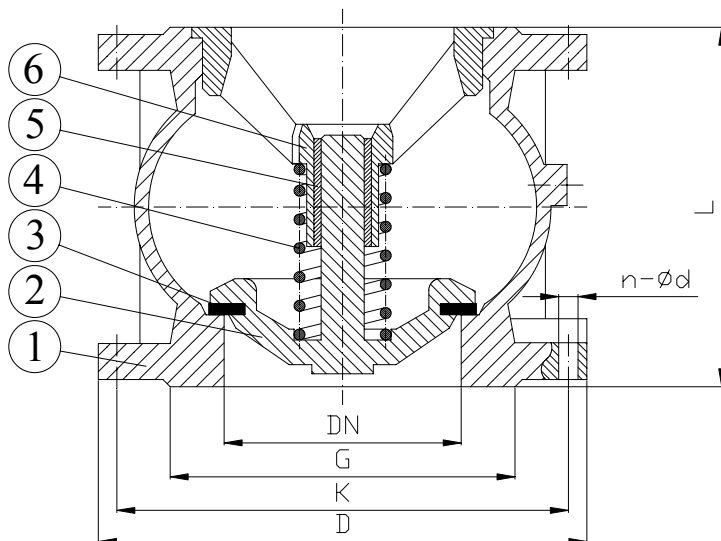
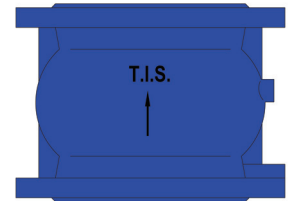

NORMA PROGETTO: EN 1074-3
SCARTAMENTO: EN 558-1
FLANGE: EN1092-2
COLLAUDI: EN 12266
TEMP. ESERCIZIO: Min -10°C/Max+70°C
PRESSIONE ESERCIZIO: Min 0,3 bar

DESIGN STANDARD: EN 1074-3
FACE TO FACE: EN 558-1
FLANGES: EN1092-2
TESTS: EN 12266
WORKING TEMP.: Min -10°C/Max+70°C
WORKING PRESSURE: Min 0,3 bar

DENOMINAZIONE PART MATERIALI MATERIALS

DENOMINAZIONE PART	MATERIALI MATERIALS
1 CORPO BODY	GJL 250 GJL 250
2 DISCO DISC	GJS 400 GJS 400
3 GUARNIZIONE SEAL	EPDM EPDM
4 MOLLA SPRING	ACCIAIO INOX STAINLESS STEEL
5 GUIDA GUIDE	OTTONE BRASS
6 GUIDA GUIDE	GJS 400 GJS 400

DN	PN	G	K	D	n-ød	L	W(kg)
50	16	98	125	165	4-19	100	5.7
65	16	118	145	185	4-19	120	8.7
80	10	132	160	200	4-19	140	10.8
	16	132	160	200	8-19	140	10.8
100	16	156	180	220	8-19	170	13.5
125	16	184	210	250	8-19	200	21
150	16	211	240	285	8-23	230	30
	10	260	295	340	8-23	300	49
200	16	260	295	340	12-23	300	49
	10	319	350	405	12-23	370	73.3
250	16	319	355	405	12-28	370	73.3
	10	370	400	445	12-23	410	90
300	16	370	410	460	12-28	410	90

RIVESTIMENTO ESTERNO/INTERNO: Polvere epossidica di colore blu RAL 5005 con spessore min 200µm.
SURFACE PROTECTION: FBE coating process with epoxy resin powder of sky blue color RAL 5005 and minimum thickness of 200µm.

FILTRO DI FONDO A CESTELLO, FLANGIATO

FILTER, FLANGED

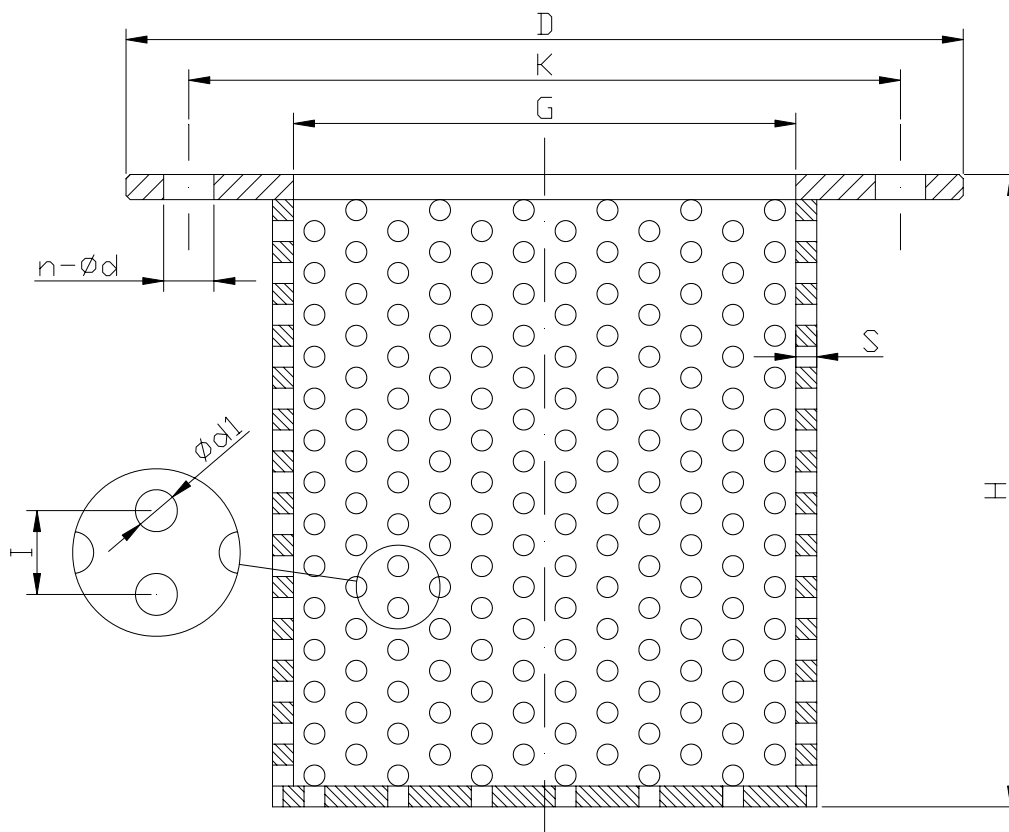

**DENOMINAZIONE
PART**

**MATERIALI
MATERIALS**

**CORPO
BODY**

LAMIERA IN ACCIAIO ZINCATO
ZINC PLATED SHEET STEEL

DN	G	K	D	n-ød	S	H	l	ød1
50	108	127	156	4-9	2	80	9	6
65	128	147	176	4-9	2	100	9	6
80	144	164	202	4-9	2	120	9	6
100	164	184	212	4-9	2	150	9	6
125	194	214	242	4-9	2	175	9	6
150	218	240	276	4-9	2	200	9	6
200	274	295	332	6-9	2	250	9	6
250	325	355	385	6-9	2	300	9	6
300	386	410	445	6-9	2	350	9	6
350	446	470	505	8-11	2	400	9	6
400	498	525	565	8-11	2	450	9	6