

PN10 - Art. 054006

PN25 - Art. 054012

## GIUNTO ISOLANTE SALDARE/SALDARE

## INSULATING JOINT WELDING/WELDING

## APPLICAZIONE:

Gas ed acqua (PN 25 per condotta)

## APPLICATION:

Gas and water

**NORME PRODOTTO:** UNI - CIG 10284 (per PN10)  
UNI - CIG 10285 (per PN25)

**TEMPERATURA DI ESERCIZIO:** da -15 a + 70°C

**TENSIONE DI ISOLAMENTO IN ARIA:** 3Kv

**RESISTENZA DI ISOLAMENTO IN ARIA:** 5MΩ

**VERNICE EPOSSIFENOLICA**

**PRODUCT STANDARDS:** UNI - CIG 10284 (for PN10)  
UNI - CIG 10285 (for PN25)

**WORKING TEMPERATURE:** from -15 to + 70°C

**DIELECTRIC RESISTANCE IN DRY AIR:** 3Kv

**ELECTRICAL ISULATION RESISTENCE IN DRY AIR:** 5MΩ

**EPOXYPHENOLIC PAINTING**

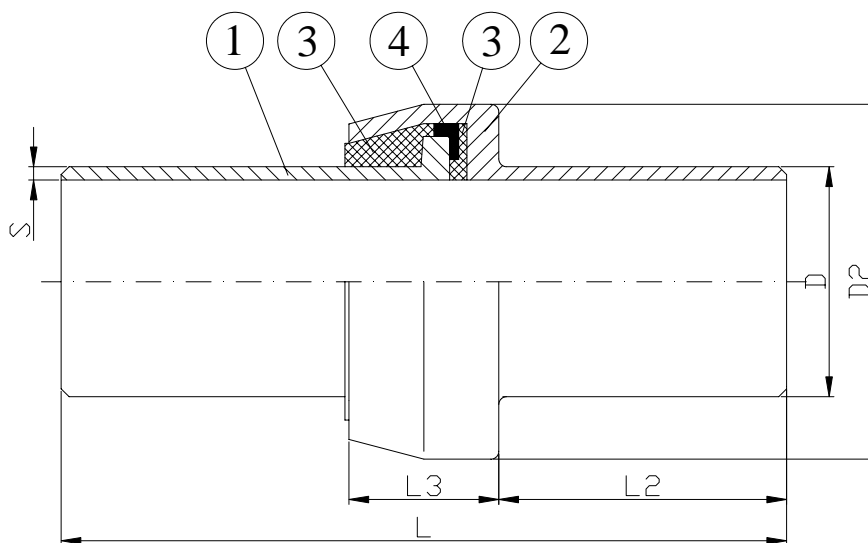

DN	D		D2		L		L2		L3		S	
	PN 10	PN 25	PN 10	PN 25	PN 10	PN 25	PN 10	PN 25	PN 10	PN 25	PN 10	PN 25
20	26.7	26.7	53	55	225	230	96	96	32	38	3.25	3.25
25	33.4	33.4	60	63	245	250	105	105	35	42	3.38	3.38
32	42.2	42.2	71	74	270	280	117	117	36	46	3.56	3.56
40	48.3	48.3	77	80	280	290	121	121	37	48	3.68	3.68
50	60.3	60.3	90	95	290	300	126	126	38	50	3.91	3.91
65	76.1	76.1	113	114	330	330	137	139	53	52	5.0	5.0
80	88.9	88.9	127	127	400	400	172	172	56	56	5.49	5.49
100		114.3		153		400		168		64		6.02
125		141.3		192		500		213		74		4.78
150		168.3		219		500		210		80		4.78
200		219.1		273		500		205		90		6.35
250		273.0		340		700		290		120		6.35
300		323.9		398		700		283		134		6.35

DENOMINAZIONE  
PARTMATERIALI  
MATERIALS

1	TRONCHETTO HOT FORGED SPIGOT	API 5L Gr.B API 5L Gr.B
2	BICCHIERE HOT FORGED SOCKET	ACCIAIO ASTM-A105 STEEL ASTM-A105
3	GUARNIZIONE GASKET	HYTREL(PN10)/NBR(PN25) HYTREL(PN10)/NBR(PN25)
4	DISTANZIATORE SPACER	POLICARBONATO POLYCARBONATE

## GIUNTO ISOLANTE MASCHIO/SALDARE PN10

## INSULATING JOINT MALE/WELDING PN10

## APPLICAZIONE:

Gas ed acqua

## APPLICATION:

Gas and water

NORME PRODOTTO: UNI - CIG 10284

TEMPERATURA DI ESERCIZIO: da -15 a + 70°C

TENSIONE DI ISOLAMENTO IN ARIA: 3Kv

RESISTENZA DI ISOLAMENTO IN ARIA: 5MΩ

FILETTATURE: Maschio conica UNI ISO R 7/1

VERNICE EPOSSIFENOLICA

PRODUCT STANDARDS: UNI - CIG 10284

WORKING TEMPERATURE: from -15 to + 70°C

DIELECTRIC RESISTANCE IN DRY AIR: 3Kv

ELECTRICAL ISULATION RESISTANCE IN DRY AIR: 5MΩ

THREADS: External taper thread in accordance to UNI ISO R 7/1

EPOXYPHENOLIC PAINTING

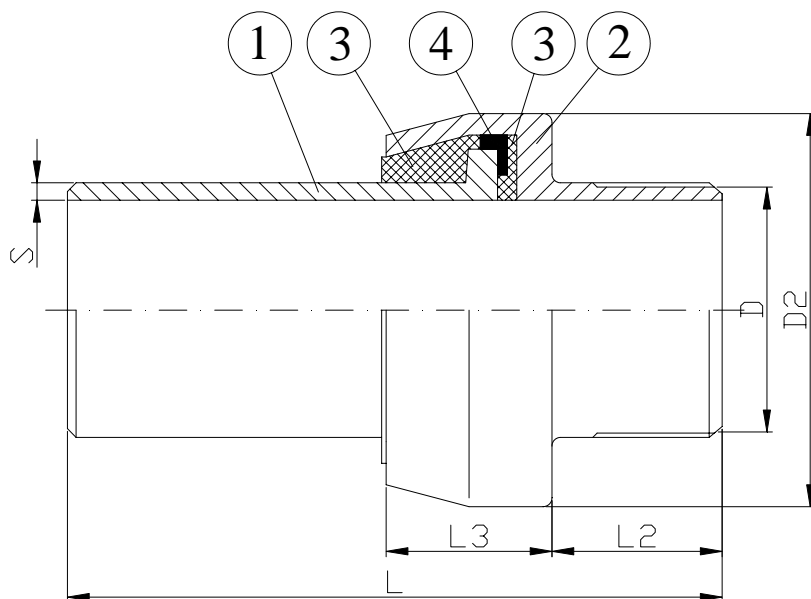

DN	D	D2	L	L2	L3	S
20	26.7	53	110	27	30	3.25
25	33.4	60	120	29	32	3.38
32	42.2	71	135	32	35	3.56
40	48.3	77	145	32	37	3.68
50	60.3	90	150	36	38	3.91
65	76.1	113	170	40	53	5.0
80	88.9	127	200	44	53	5.49
100	114.3	156	220	55	65	6.02

DENOMINAZIONE  
PARTMATERIALI  
MATERIALS

1	TRONCHETTO HOT FORGED SPIGOT	API 5L Gr.B API 5L Gr.B
2	BICCHIERE HOT FORGED SOCKET	ACCIAIO ASTM-A105 STEEL ASTM-A105
3	GUARNIZIONE GASKET	HYTREL 40 D DUPONT HYTREL 40 D DUPONT
4	DISTANZIATORE SPACER	POLICARBONATO POLYCARBONATE

**GIUNTO ISOLANTE MASCHIO/FEMMINA PN10**

**INSULATING JOINT MALE/FEMALE PN10**

**APPLICAZIONE:**

Gas ed acqua

**APPLICATION:**

Gas and water

**NORME PRODOTTO:** UNI - CIG 10284

**TEMPERATURA DI ESERCIZIO:** da -15 a + 70°C

**TENSIONE DI ISOLAMENTO IN ARIA:** 3Kv

**RESISTENZA DI ISOLAMENTO IN ARIA:** 5MΩ

**FILETTATURE:** Maschio conica UNI ISO R 7/1

Femmina cilindrica UNI ISO Rp 7/1

**VERNICE EPOSSIFENOLICA**

**PRODUCT STANDARDS:** UNI - CIG 10284

**WORKING TEMPERATURE:** from -15 to + 70°C

**DIELECTRIC RESISTANCE IN DRY AIR:** 3Kv

**ELECTRICAL ISULATION RESISTENCE IN DRY AIR:** 5MΩ

**THREADS:** External taper thread in accordance to UNI ISO R 7/1

Internal parallel thread in accordance to UNI ISO Rp 7/1

**EPOXYPHENOLIC PAINTING**

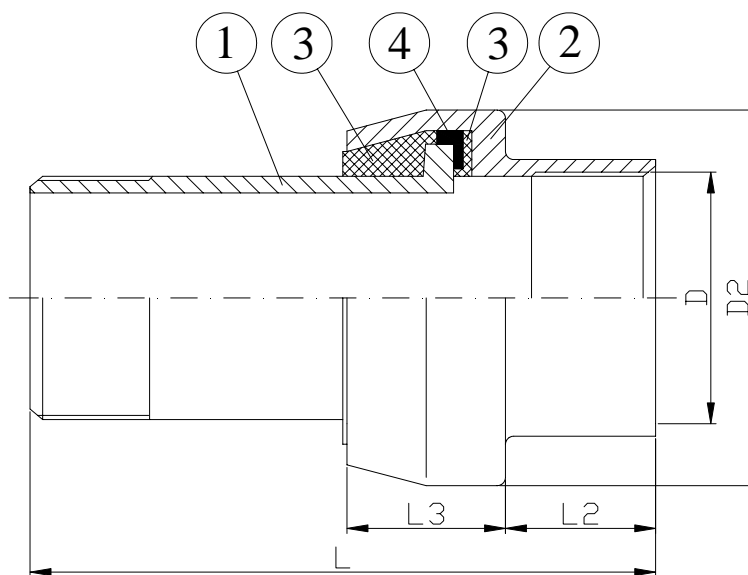

DN	D	D2	L	L2	L3
20	26.7	53	110	27	30
25	33.4	60	120	29	32
32	42.2	71	135	32	35
40	48.3	77	145	32	37
50	60.3	90	150	36	38
65	76.1	113	170	40	53
80	88.9	127	200	44	53
100	114.3	156	220	55	65

DENOMINAZIONE PART	MATERIALI MATERIALS
1 TRONCHETTO HOT FORGED SPIGOT	API 5L Gr.B API 5L Gr.B
2 BICCHIERE HOT FORGED SOCKET	ACCIAIO ASTM-A105 STEEL ASTM-A105
3 GUARNIZIONE GASKET	HYTREL 40 D DUPONT HYTREL 40 D DUPONT
4 DISTANZIATORE SPACER	POLICARBONATO POLYCARBONATE