

GIUNTO ISOLANTE MASCHIO/SALDARE PN10

INSULATING JOINT MALE/WELDING PN10

APPLICAZIONE:

Gas ed acqua

APPLICATION:

Gas and water

NORME PRODOTTO: UNI - CIG 10284

TEMPERATURA DI ESERCIZIO: da -15 a + 70°C

TENSIONE DI ISOLAMENTO IN ARIA: 3Kv

RESISTENZA DI ISOLAMENTO IN ARIA: 5MΩ

FILETTATURE: Maschio conica UNI ISO R 7/1

VERNICE EPOSSIFENOLICA

PRODUCT STANDARDS: UNI - CIG 10284

WORKING TEMPERATURE: from -15 to + 70°C

DIELECTRIC RESISTANCE IN DRY AIR: 3Kv

ELECTRICAL ISULATION RESISTANCE IN DRY AIR: 5MΩ

THREADS: External taper thread in accordance to UNI ISO R 7/1

EPOXYPHENOLIC PAINTING

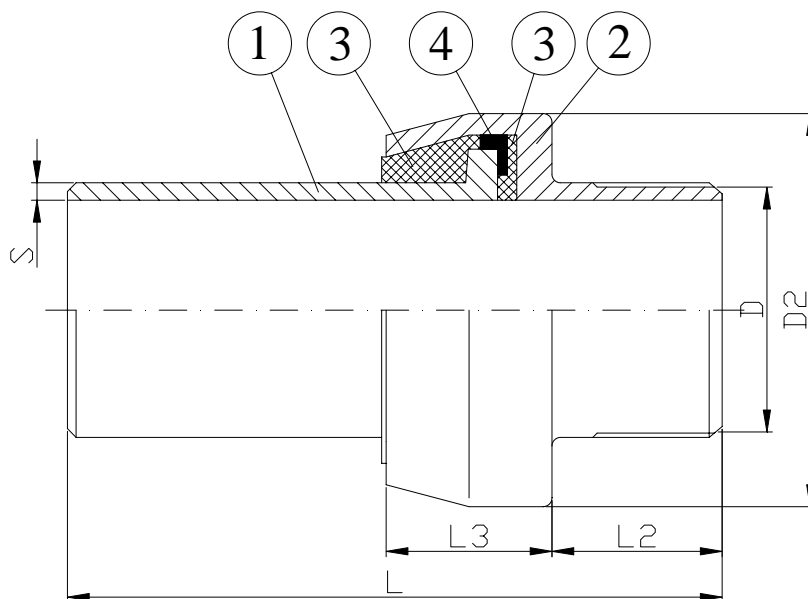

DN	D	D2	L	L2	L3	S
20	26.7	53	110	27	30	3.25
25	33.4	60	120	29	32	3.38
32	42.2	71	135	32	35	3.56
40	48.3	77	145	32	37	3.68
50	60.3	90	150	36	38	3.91
65	76.1	113	170	40	53	5.0
80	88.9	127	200	44	53	5.49
100	114.3	156	220	55	65	6.02

DENOMINAZIONE
PARTMATERIALI
MATERIALS

1	TRONCHETTO HOT FORGED SPIGOT	API 5L Gr.B API 5L Gr.B
2	BICCHIERE HOT FORGED SOCKET	ACCIAIO ASTM-A105 STEEL ASTM-A105
3	GUARNIZIONE GASKET	HYTREL 40 D DUPONT HYTREL 40 D DUPONT
4	DISTANZIATORE SPACER	POLICARBONATO POLYCARBONATE